

Rekluse Motor Sports

TCS Clutch Baskets

KX/RM65

2000 – 2006

Installation Guide

Copyright 2006 Rekluse Motor Sports

TCS Revision 1.000

RMS 4140

195-4140

Manual Revision: 061406

Rekluse Motor Sports, Inc.

110 E. 43rd Street

Boise, Idaho 83714

208-426-0659

support@rekluse.com

Required Tools To Assemble Basket

1/4-inch Driver	Torque Wrench
High Strength Red Loctite	

Basket Overview

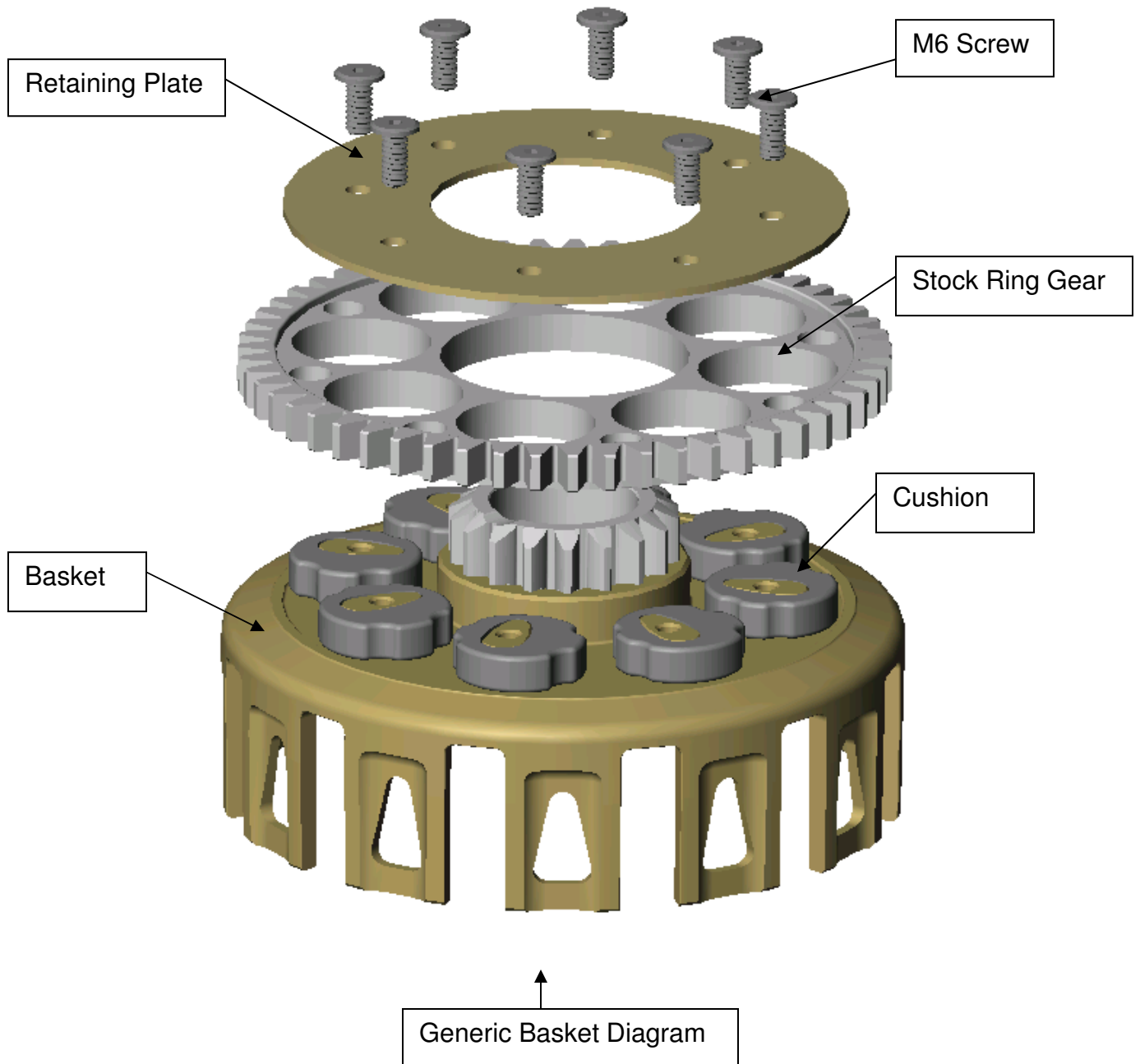

Included Parts

TCS Clutch Basket Core	6 – M6 x 1 x 10 Socket Head Screws
Retaining Plate	M3 Allen Socket



Bike Preparation and Disassembly

1. Following the procedures in the OEM service manual, remove the existing clutch basket from the engine.
2. Remove the rivets holding the primary ring gear to the OEM aluminum clutch basket. The rivets can be removed by milling, drilling, or grinding the heads off of the ring gear side of the OEM basket. **See picture next page.**



Warning: When removing the OEM rivets, do not damage the steel ring gear as it will be used with your new Rekluse TCS Clutch Basket.

3. Remove the OEM retaining plate, cushions, and ring gear from the OEM basket taking note of how everything will be reassembled. The OEM cushions and ring gear will be re-used with your Rekluse TCS Clutch Basket.
4. Install the OEM cushions onto the Rekluse TCS Clutch Basket. **See following picture.**

The KX/RM 65 Basket has 6 dampeners and they are round.

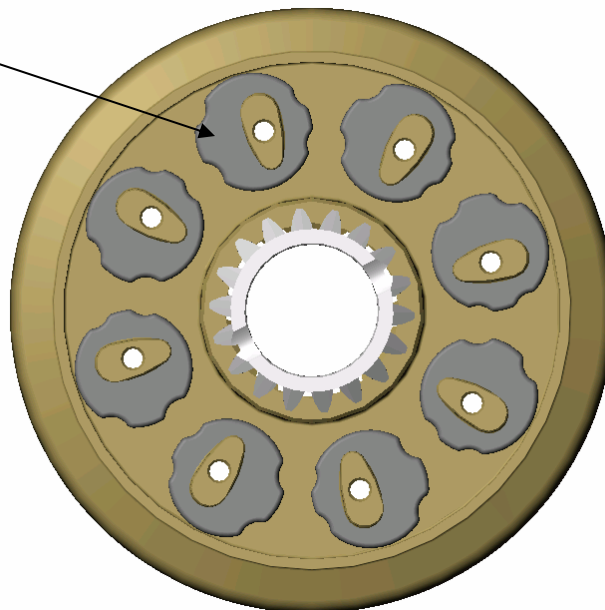

5. Install the OEM ring gear and new retaining plate onto the Rekluse TCS Clutch Basket. **See following picture.**

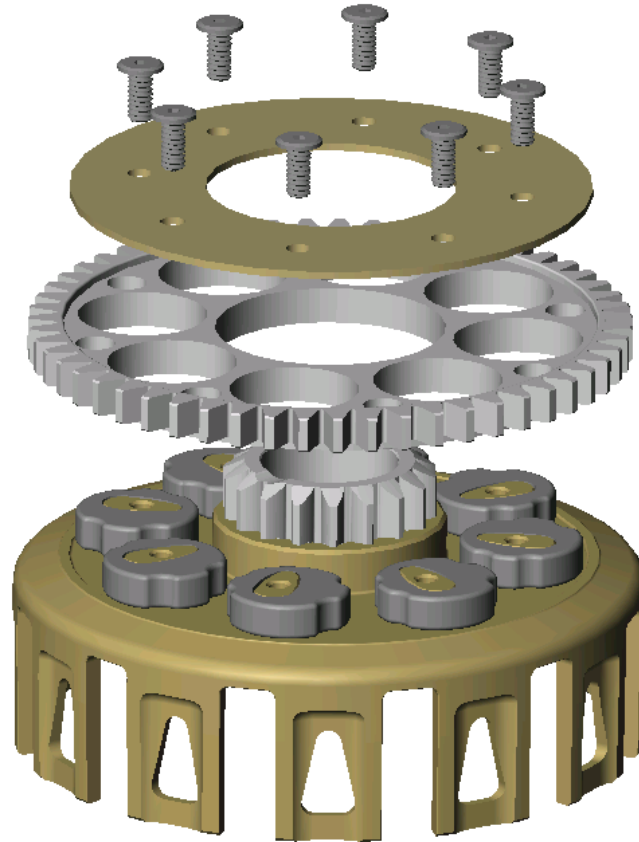

6. Apply **high strength red Loctite** to the M6 fasteners and install them into the clutch basket assembly. Tighten to 80 in-lbs (6.6 ft-lbs) in a criss-cross pattern to compress the assembly evenly.



7. Using a hammer and punch, peen over the ends of the screws where they come through the bottom-inside of the clutch basket. **See following picture.**



8. Install the new clutch basket assembly into the engine following the procedures in the OEM service manual.
9. For z-Start installation, refer to the z-Start Installation Guide that was included with the z-Start Clutch. For re-installing your stock clutch follow the procedures in the OEM service manual.