

Rekluse Motor Sports

TCS Clutch Baskets

YZ 450F

2003 – 2006

Installation Guide

Copyright 2006 Rekluse Motor Sports

TCS Revision 1.000

RMS 4172

195-4172

Manual Revision: 122805

Rekluse Motor Sports, Inc.

110 E. 43rd Street

Boise, Idaho 83714

208-426-0659

support@rekluse.com

Required Tools To Assemble Basket

1/4-inch Driver

Torque Wrench

Basket Overview

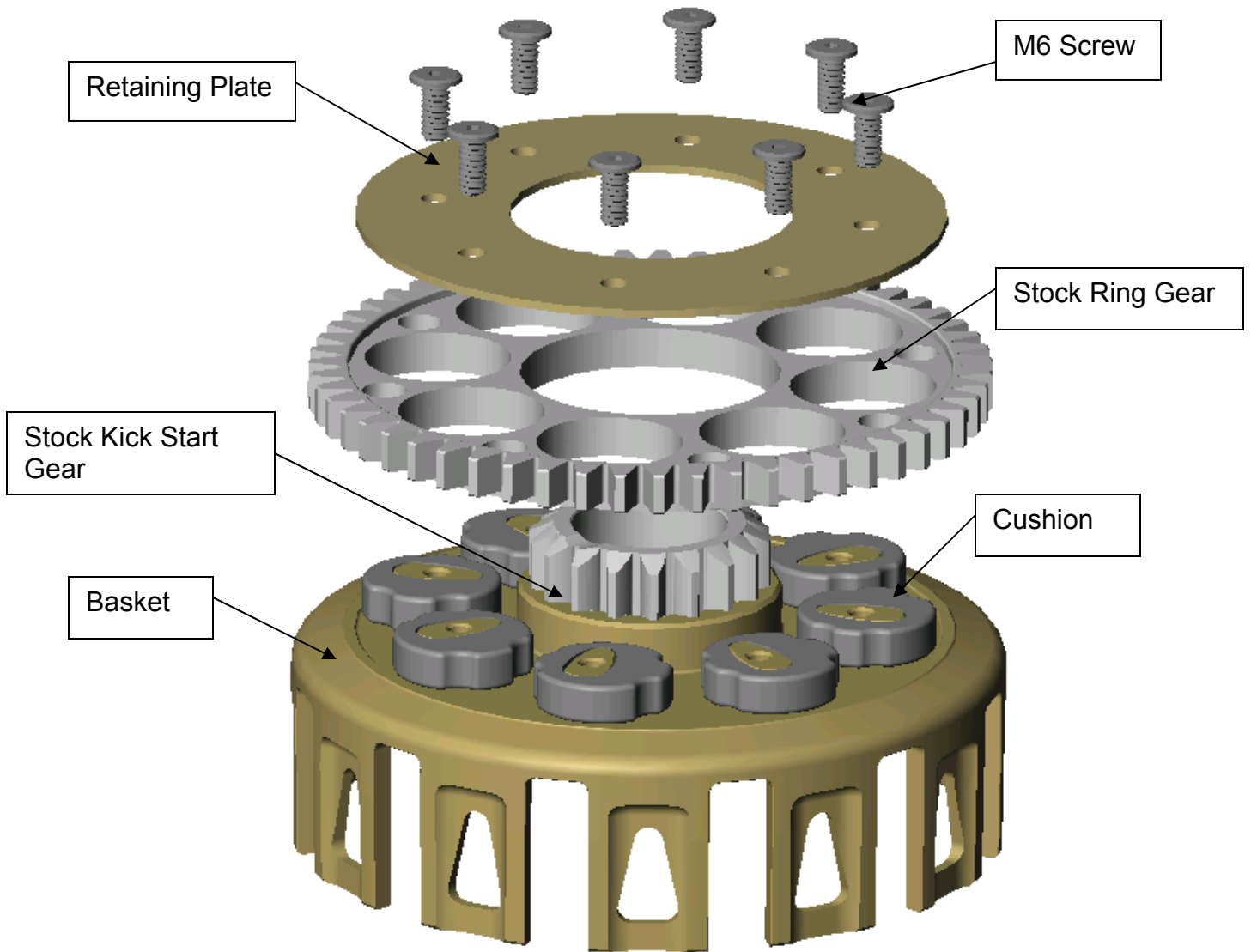

Included Parts

TCS Clutch Basket Core	8 – M6 x 1 x 10 Socket Head Screws
Retaining Plate	M3 Allen Socket

Bike Preparation and Disassembly

1. Following the procedures in the OEM service manual, remove the existing clutch basket from the engine.
2. Remove the rivets holding the primary ring gear to the OEM aluminum clutch basket. The rivets can be removed by milling, drilling, or grinding the heads off of the ring gear side of the OEM basket. **See following picture.**



Warning: When removing the OEM rivets, do not damage the steel ring gear as it will be used with your new Rekluse TCS Clutch Basket.

3. Remove the OEM retaining plate, cushions, and ring gear from the OEM basket taking note of how everything will be reassembled. The OEM cushions and ring gear will be re-used with your Rekluse TCS Clutch Basket.
4. Press the kick-starter gear out of the OEM basket.

Warning: Do not damage the kick-starter gear during disassembly, as it will be used with your new Rekluse TCS Clutch Basket.

5. Kick-starter gear installation: To get the gear to drop into the new basket easily, place the basket in the oven at 400° F and the kick start gear in the freezer for 15 minutes.

Remove the basket from the oven, and quickly drop the gear into the center hole. Place a weight on the gear to hold it in place until the basket cools completely. **See following picture.**

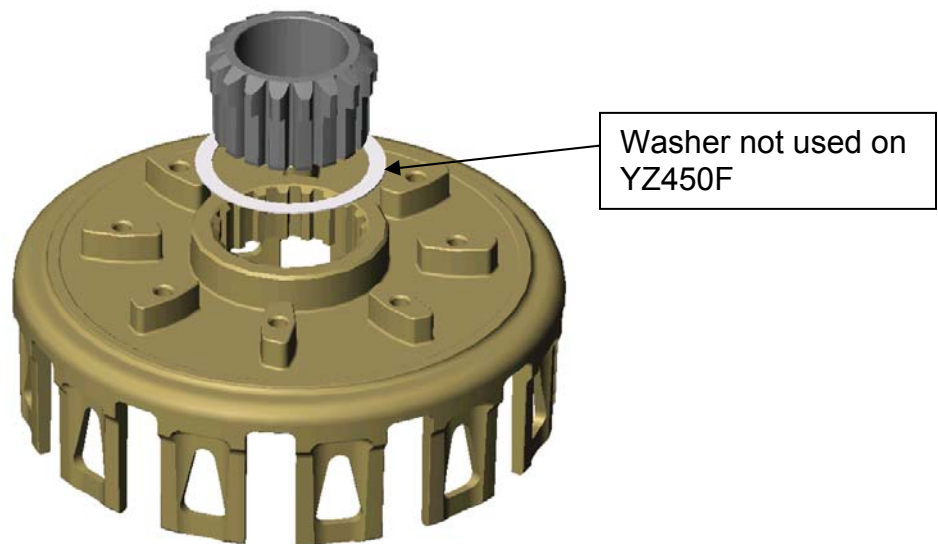

6. Install the OEM cushions onto the Rekluse TCS Clutch Basket. Install the cushions so that the thicker side of each is to the left. **See following picture.**

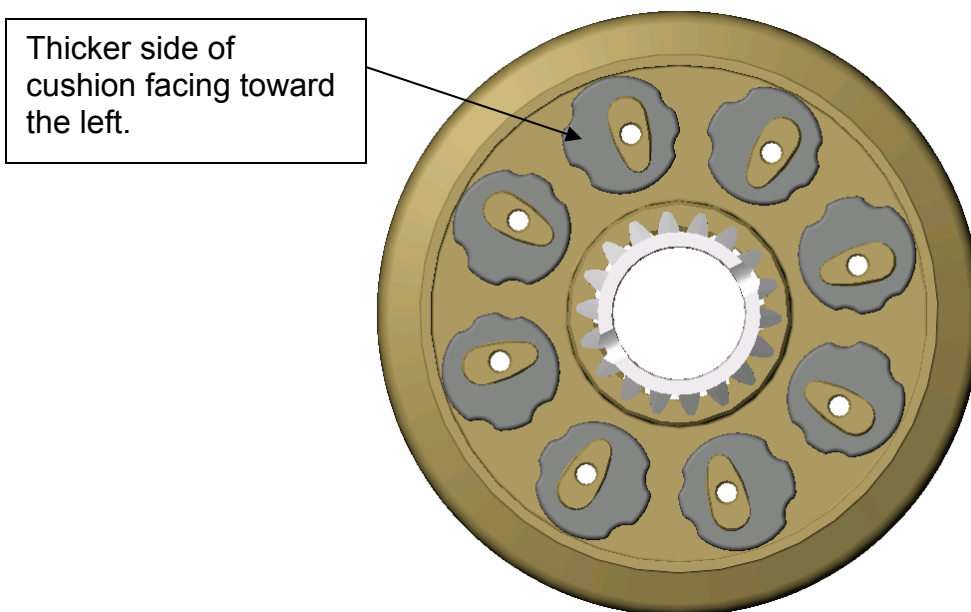

7. Install the OEM ring gear and new retainer plate onto the Rekluse TCS Clutch Basket. **See following picture.**

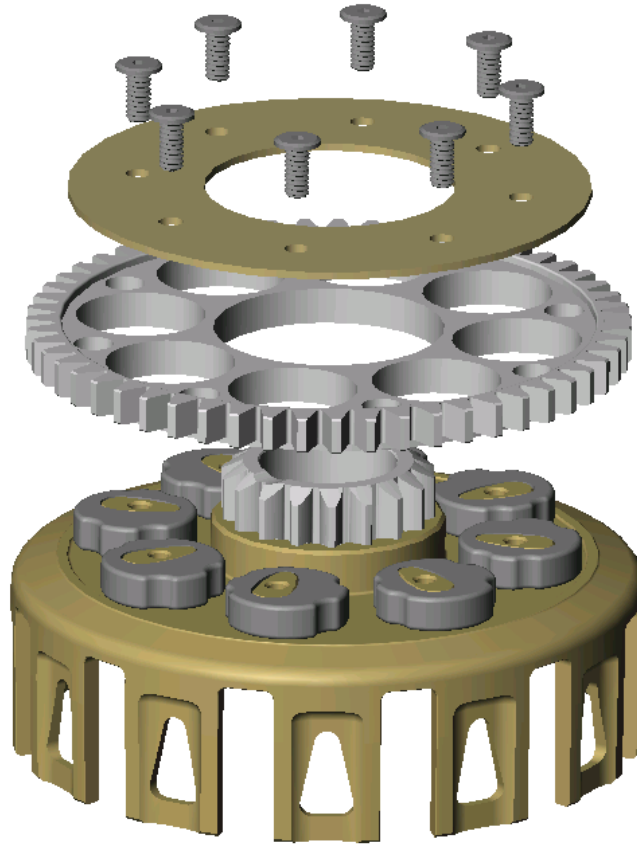

8. Install the new M6 fasteners into the clutch basket assembly. Tighten to 80 in-lbs (6.6 ft-lbs) in a criss-cross pattern to compress the assembly evenly.

9. Using a hammer and punch, peen over the ends of the screws where they come through the bottom-inside of the clutch basket. **See following picture.**



10. Install the new clutch basket assembly into the engine following the procedures in the OEM service manual.
11. For z-Start installation, refer to the z-Start Installation Guide that was included with the z-Start Clutch. For re-installing your stock clutch follow the procedures in the OEM service manual.